

Add SAFETY and EFFICIENCY to your lab

SafeStream™ **flexible faucet adaptor**



Avoid hazardous splashing accidents.

It only took one episode of being splashed by phenol left in tubes in the lab sink to inspire the SafeStream™ flexible faucet adaptor.

This unique product produces a controlled, low-velocity water stream to prevent splashing accidents in and around lab sinks. SafeStreams can be positioned into any shape for easy cleaning and filling of lab vessels inside or outside the sink. Autoclavable and available in three lengths to fit most needs.

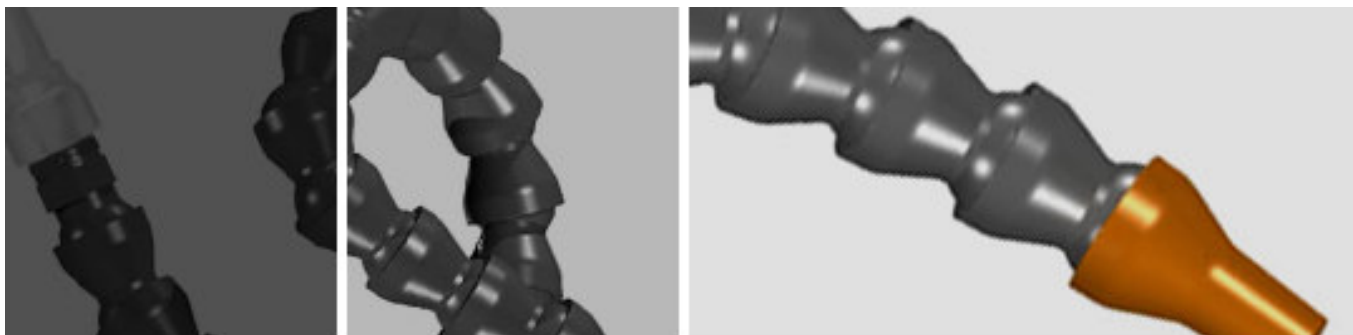

Features:

- **Fits any lab faucet with a standard 3/8"-NPT thread**
- **Suitable for fresh water or DI feeds**
- **Low velocity to reduce splashing**
- **Fully directional – stays positioned and does not spring-back**
- **Bending will not constrict the internal diameter**
- **No plasticizer that contaminates water streams**
- **Autoclavable**
- **Ready to use – no assembly required**
- **Longer lengths available for filling vessels outside the sink**

	<u>Part #</u>	<u>Price</u>
SafeStream S (10")	EK-76109	\$55
SafeStream M (20")	EK-76103	\$65
SafeStream L (30")	EK-76110	\$85

www.biocision.com

1.888.478.2221

biocision products are available through:



E&K SCIENTIFIC

E&K Scientific

3575 Thomas Road
Santa Clara, CA 95054

Tel: 1.800.934.8114

Fax: 408.567.9671

Email: service@eandkscientific.com

Web: <http://www.eandkscientific.com>